

enquiries@urbanspec.co.uk
01227 200404
www.urbanspec.co.uk

urbanspec is a brand of Streetspace Ltd
Streetspace Ltd, Lympne Industrial Park, Otterpool Lane, Hythe, Kent CT21 4LR

STREETSPACE LIMITED, Registered in England and Wales: 10175199. The content of this document is for your general information and use only.



Storage Building Roof Specification



urbanspec

External storage systems, bike parking and street furniture

urbanspec Bike Stores - Roof Types

urbanspec bin and bike stores are designed for ease of specification either pre-engineered or bespoke. The configurable approach extends to roof design systems where there are a number of factors to consider including site security requirements, planning conditions and biodiversity net gain considerations.

In standard configuration, urbanspec bin and bike stores have a profiled steel roofing system. An enclosure only specification is available where site conditions do not require a roof covering.

External bin and bike stores are ideally suited to green roof applications, helping increase biodiversity on new developments, increasing CO2 capture, reducing rainwater run-off and enabling the softening effect of nature on the urban landscape.

Specified with either extensive or intensive lightweight green roof systems, urbanspec H-Series extensive systems support primarily sedum plants, while the intensive version with an increased substrate depth, supports a mix of sedum and wildflower plants.

There are five urbanspec Roof Design Systems:

1. **urbanspec H-Series Standard Steel Profiled Roof System**
2. **urbanspec H-Series Steel Profile / Fire Resistant (FR) Liner Roof System**
3. **urbanspec H-Series Green Roof System (Intensive)**
4. **urbanspec H-Series Green Roof System (Extensive)**
5. **urbanspec H-Series Enclosure Only Specification**

1. urbanspec H-Series Standard Steel Profiled Roof System

- 1 Steel trapezoidal profile 32/1000mm sheet. Colour coat anthracite grey outer / white lower
- 2 Steel RHS rafter sections / HD Galvanised finish
- 3 Steel RHS eaves beam / HD Galvanised (optional colour powder coat) finish
- 4 Steel box profile gutter section / Galvanised (optional colour powder coat) finish

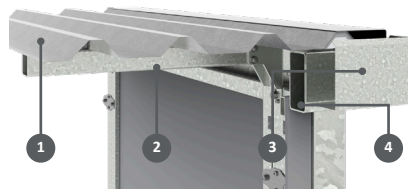

2. urbanspec H-Series Steel Profile / Fire Resistant (FR) Liner Roof System

- 1 Steel trapezoidal profile 32/1000mm sheet. Colour coat anthracite grey outer / white lower
- 2 Non-Combustible Fire Protection Board
- 3 Steel trapezoidal profile liner sheet
- 4 Steel RHS rafter sections / HD Galvanised finish
- 5 Steel RHS eaves beam / HD Galvanised (optional colour powder coat) finish
- 6 Steel box profile gutter section / Galvanised (optional colour powder coat) finish

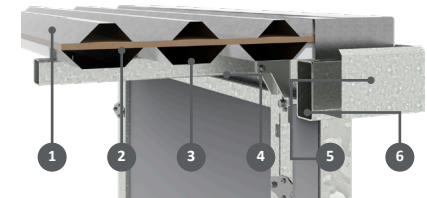

3. urbanspec H-Series Green Roof System (Intensive)

- 1 Vegetation mat pre-planted sedum and wildflower mix
- 2 Green roof substrate blend of lightweight water retaining aggregates and composted organic material
- 3 Drainage Reservoir System double-sided to provide drainage and water retention made from recycled plastic
- 4 Root Membrane geotextile lining sheet preventing any damage to the waterproof liner during installation or establishment phase
- 5 Waterproof single sheet EPDM liner which is 100% synthetic and UV resistant
- 6 Green roof structural deck constructed from full-length trapezoidal profile steel sheet with double sided zinc and paint finish
- 7 Steel RHS eaves beam / Profiled steel fascia galvanised (optional colour powder coat) finish
- 8 Steel box profile gutter section galvanised (optional colour powder coat) finish

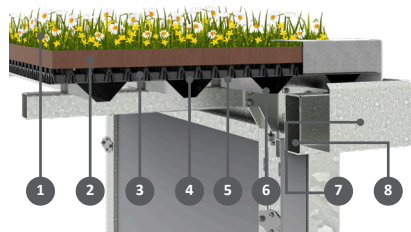

4. urbanspec H-Series Green Roof System (Extensive)

- 1 Vegetation mat pre-planted sedum mix
- 2 Green roof mineral wool based growing medium felt
- 3 Drainage Reservoir System double-sided to provide drainage and water retention made from recycled plastic
- 4 Root Membrane geotextile lining sheet preventing any damage to the waterproof liner during installation or establishment phase
- 5 Waterproof single sheet EPDM liner which is 100% synthetic and UV resistant
- 6 Green roof structural deck constructed from full-length trapezoidal profile steel sheet with double sided zinc and paint finish
- 7 Steel RHS eaves beam / Profiled steel fascia galvanised (optional colour powder coat) finish
- 8 Steel box profile gutter section galvanised (optional colour powder coat) finish

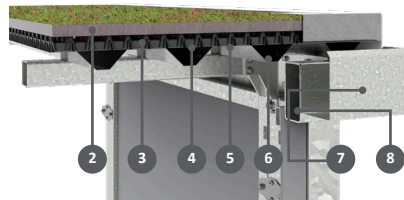

5. urbanspec H-Series Enclosure Only Specification

- 1 Steel RHS Column Sections / HD Galvanised
- 2 Steel box profile panel trim galvanised finish

